

SMT Power Inductor (MOLDING TYPE)

MPL13X Type

Features

- RoHS compliant.
- Low profile, high current SMD type.
- Frequency range up to 1MHz.
- Lowest DCR/ μ H, in this package size.
- Low buzz noise due to its gap-less structure.

Applications

- Notebook/Desktop/Server/Video Card applications.
- High current POL converters.
- Low profile, high current power supplies.
- Battery powered devices.
- Ideal for power source circuits, DC-DC converter.
- DC-AC inverters inductor application.

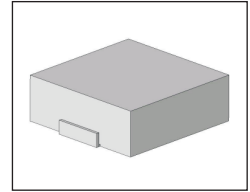

Mechanical Dimension:

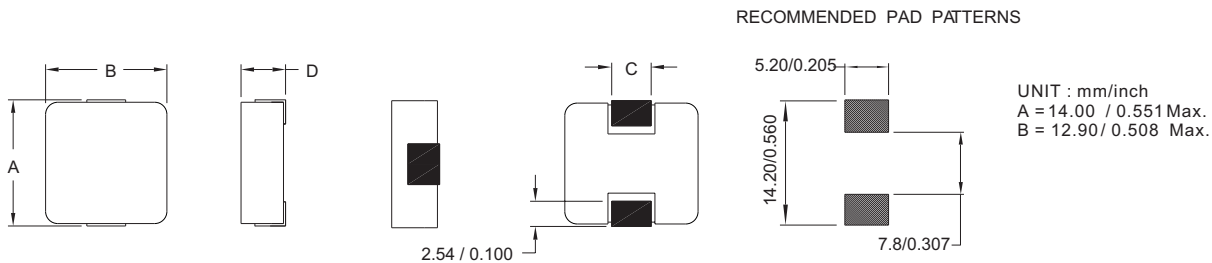

Electrical Characteristics: At 25°C: 100KHz, 0.25V

PART NO.	Lo ¹ (μ H)	DCR (m Ω) TYP.	DCR (m Ω) MAX.	Isat ¹ (A dc)	Ir ² (A dc)	Dimension "C" mm / inch $\pm 0.5 / \pm 0.02$	Dimension "D" mm / inch MAX
MPL133-R68	0.68 \pm 20%	1.80	2.30	49	28	4.0 / 0.157	3.5 / 0.138
MPL133-1R0	1.00 \pm 20%	3.30	3.60	40	24	2.6 / 0.102	3.5 / 0.138
MPL135-0R4	0.40 \pm 20%	0.72	0.85	65	42	4.7 / 0.185	5.0 / 0.197
MPL135-R47	0.47 \pm 20%	0.85	1.10	65	42	4.7 / 0.185	5.0 / 0.197
MPL135-R56	0.56 \pm 20%	1.30	1.50	55	38	4.7 / 0.185	5.0 / 0.197
MPL136-1R0	1.00 \pm 20%	1.90	2.30	49	32	4.2 / 0.165	6.5 / 0.256
MPL136-1R5	1.50 \pm 20%	2.50	2.80	45	28	4.2 / 0.165	6.5 / 0.256
MPL136-1R8	1.80 \pm 20%	2.80	3.20	41	24	4.2 / 0.165	6.5 / 0.256
MPL136-2R2	2.20 \pm 20%	3.50	4.20	40	22	4.0 / 0.157	6.5 / 0.256
MPL136-3R3	3.30 \pm 20%	3.90	4.50	35	19	4.0 / 0.157	6.5 / 0.256

1. Isat is the DC current which cause the inductance drop approximately 30% of its nominal inductance without current.
2. Ir is the DC current which cause the surface temperature of the part increase approximately than 40°C.



DELTA ELECTRONICS, INC.

(TAOYUAN PLANT CPBG) 252, SAN YING ROAD, KUEISAN INDUSTRIAL ZONE, TAOYUAN SHIEN, 333, TAIWAN, R.O.C.

TEL: 886-3-3591968; FAX: 886-3-3591991

<http://www.deltawww.com>